

RECORD MODEL 50A

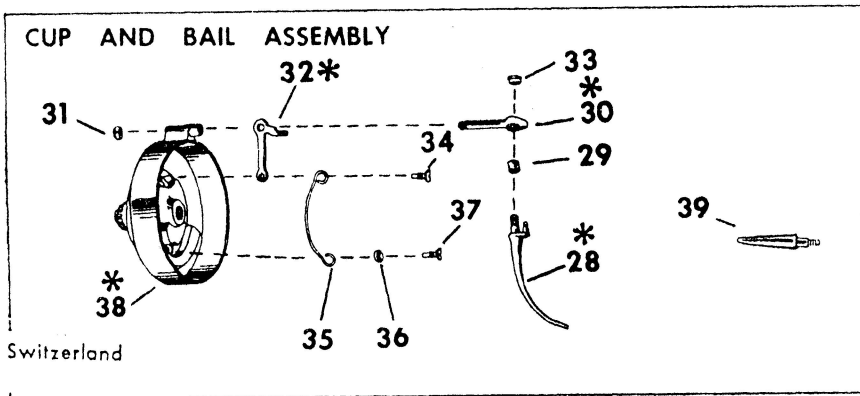

Printed in Switzerland

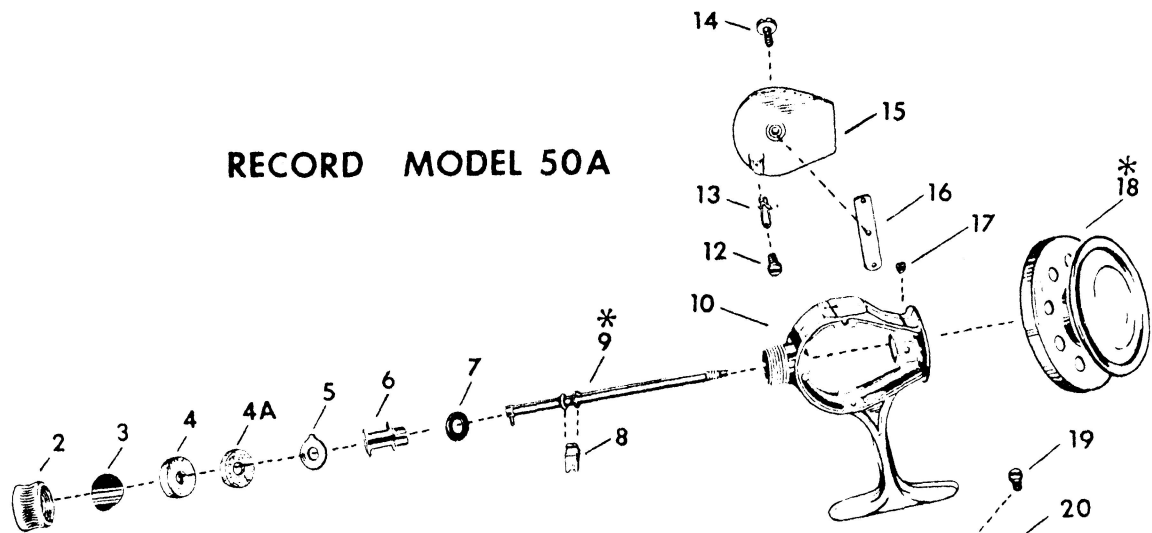
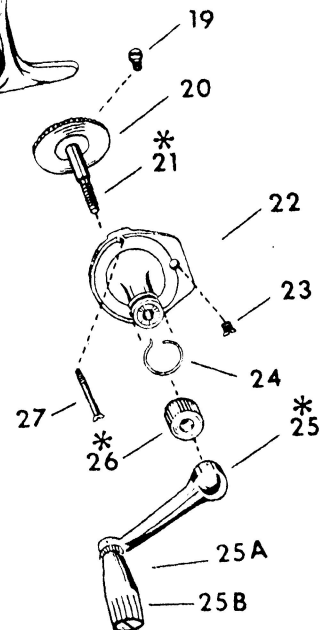

*NOTE:
THESE PARTS AVAILABLE FOR
RIGHT OR LEFT HAND REELS.

PLEASE ORDER BY PART NUMBER

REF. PART NO.	PART NO.	PART NAME	PRICE	REF. PART NO.	PART NO.	PART NAME	PRICE	REF. PART NO.	PART NO.	PART NAME	PRICE
2	5050-7	Drag Cap	1.00	16	5051-16	Cross Bar	.40	28*	5051-28 R/L	Finger	1.75
3	5050-47	Drag Pressure Spring	.10	17	5050-41	Housing Set Screw	.10	29	5050-2	Line Roller	.30
4	5050-10	Felt Washer	.05	18*	5051-22 R/L	Plastic Spool	1.75	30*	5051-30 R/L	Finger Stem	.50
4A	5051-50	Thin Felt Washer	.10	19	5050-19	Gear Shaft Screw	.10	31	5051-31	Finger Stem Nut	.15
5	5050-9	Plastic Drag Washer	.10	20	5050-17	Wheel Gear w/Pin	2.50	32*	5051-32 R/L	Thumb Lever Switch	.25
6	5050-8	Brake Bushing	1.00	21*	5050-5 R/L	Crank Handle Shaft	1.00	33	5050-38	Bail Setting Nut	.15
7	5051-46	Thrust Washer	.10	22	5050-15	Side Plate (Crank Side)	2.50	34	5051-71	Lever Switch Screw	.10
8	5050-18	Oscillator Yoke	1.00	23	5050-23	Housing Screw (short)	.05	35	5051-2	Pick Up Spring	.10
9*	5051-11 R/L	Main Shaft	1.00	24	5050-24	Anti-Reverse Spring	.10	36	5051-83	Spacer Lever Switch	.10
10	5050-12	Housing	5.50	25*	5051-4 R/L	Crank Handle	2.00	37	5051-37	Spring Anchor Screw	.10
12	5050-44	Click Spring Screw	.10	25A	5051-20	Plastic Grip	.35	38*	5051-38 R/L	Shell w/Pinion Gear	3.50
13	5050-13	Click Spring	.10	25B	5051-84	Grip Handle Screw	.15	39	5051-52	Manual Pickup	1.00
14	5051-43	Cover Screw	.10	26*	5050-6 R/L	Knurled Clutch Ring	.75				
15	5050-14	Side Plate	.75	27	5050-27	Housing Screw (Long)	.10				